



# GUTEX Thermowall NF

## TECHNICAL DATA SHEET



GUTEX Thermowall NF is the plaster baseboard for the ecological Thermowall ETICS for use in commercial construction.

### Ingredients

- Untreated fir and spruce
- 4.0 % PUR resin
- 1.5 % paraffin

### Disposal

- Waste code numbers as per AVV 030105, 170201

Bulk density $\rho$ [kg/m <sup>3</sup> ]	~ 160
Nominal thermal conductivity $\lambda_D$ [W/mK]	0.040
Vapour diffusion $\mu$	4
Compressive stress/strength [kPa]	≥ 100
Tensile strength perpendicular to the surface [kPa]	≥ 10
Short-term water absorption [kg/m <sup>2</sup> ]	≤ 1
Air flow resistivity [kPa s/m <sup>2</sup> ]	≥ 100
Specific heat capacity [J/kgK]	2100
Maximum working temperature [°C]	110
Fire reaction Euro Class as per EN 13501-1	E
Product standard	EN 13171
Approval number	Z-33.47-660 Z-33.43-942 ETA-10/0287 ETA-10/0288
Board designation	WF-EN13171-T5-W51,0-DS(70,-)2-CS(10/Y)100-TR10-MU4-AF <sub>r</sub> 100





# **GUTEX** Thermowall NF

## Detailed information

Joint type	Tongue and groove
Thickness [mm]	60
Length × width [mm × mm]	1800 × 600
Actual coverage: Length × width [mm × mm]	1780 × 580
Actual coverage: Square metres per board [m <sup>2</sup> ]	1.03
m <sup>2</sup> /Piece(s)	1.08
Weight per board [kg]	10.40
Weight per m <sup>2</sup> [kg]	9.60
Piece(s)/Pallet	36
Square metres per pallet [m <sup>2</sup> ]	38.88
Weight per pallet [kg]	370
Nominal thermal resistance R <sub>D</sub> [m <sup>2</sup> K/W]	1.50
sd value [m]	0.24





# **GUTEX Thermowall NF**

## PRODUCT INFORMATION

### Areas of use

- Plaster baseboard for Thermowall ETICS for wood and solid construction without rear ventilation

### Advantages

- Part of the GUTEX thermal insulation system approved by the building authorities
- Shockproof
- Improvement of sound insulation
- High dimensional accuracy for time-saving and simple installation
- Single-layer, homogeneous bulk density profile
- Optimum thermal insulation
- Outstanding heat storage capacity → good protection from heat in summer and cold in winter
- Moisture-regulating
- Vapour-permeable
- Wood as the sustainable raw material → recyclable
- Manufactured in the direct vicinity of Switzerland (Waldshut, Black Forest)
- Ecologically safe (natureplus® certified)

### Installation instructions

- For full, detailed instructions on board installation, fastenings, and render application, see the brochure 'Thermowall ETICS, the ecological thermal insulation system'.
- Note the legal requirements for handling wood dust

#### Assembly over Timber or Masonry

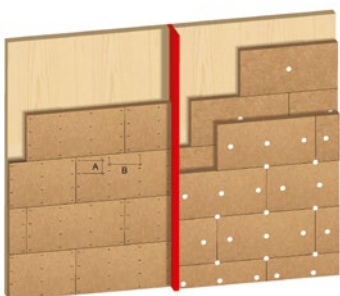

Over Timber Wall

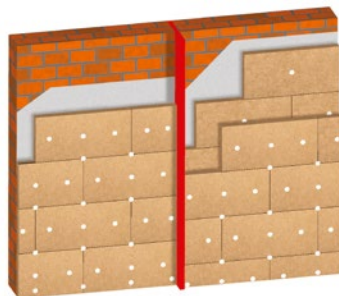

Over Masonry

#### Assembly in Timber Frame

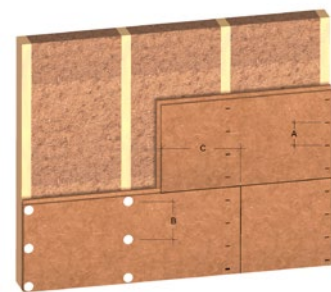

In Timber Frame

