



GUTEX Thermowall

TECHNICAL DATA SHEET



GUTEX Thermowall is the plaster baseboard with low lambda value for the ecological Thermowall ETICS.

Ingredients

- Untreated fir and spruce
- 4.0 % PUR resin
- 1.5 % paraffin

Disposal

- Waste code numbers as per AVV 030105, 170201

Bulk density ρ [kg/m ³]	~ 160
Nominal thermal conductivity λ_D [W/mK]	0.040
Vapour diffusion μ	4
Compressive stress/strength [kPa]	≥ 100
Tensile strength perpendicular to the surface [kPa]	≥ 10
Short-term water absorption [kg/m ²]	≤ 1
Air flow resistivity [kPa s/m ²]	≥ 100
Specific heat capacity [J/kgK]	2100
Maximum working temperature [°C]	110
Fire reaction Euro Class as per EN 13501-1	E
Product standard	EN 13171
Approval number	Z-33.47-660 Z-33.43-942 ETA-10/0287 ETA-10/0288
Board designation	WF-EN13171-T5-W51,0-DS(70,-)3-CS(10/Y)100-TR10-MU4-AF _r 100





GUTEX Thermowall

Detailed information

Joint type	Tongue and groove				
Thickness [mm]	80	100	120	140	160
Length × width [mm × mm]	1300 × 600				
Actual coverage: Length × width [mm × mm]	1275 × 575			1280 × 580	
Actual coverage: Square metres per board [m ²]	0.73			0.74	
m ² /Piece(s)	0.78				
Weight per board [kg]	10.00	12.50	15.00	17.50	20.00
Weight per m ² [kg]	12.80	16.00	19.20	22.40	25.60
Piece(s)/Pallet	56	44	36	32	28
Square metres per pallet [m ²]	43.68	34.32	28.08	24.96	21.84
Weight per pallet [kg]	510	520	510	530	
Nominal thermal resistance R _D [m ² K/W]	2.00	2.50	3.00	3.50	4.00
sd value [m]	0.32	0.40	0.48	0.56	0.64

Joint type	Flush-mount			
Thickness [mm]	100	120	140	160
Length × width [mm × mm]	830 × 600			
m ² /Piece(s)	0.49			
Weight per board [kg]	8.00	9.60	11.20	12.70
Weight per m ² [kg]	16.00	19.20	22.40	25.60
Piece(s)/Pallet	40	32	28	24
Square metres per pallet [m ²]	19.92	15.93	13.94	11.95
Weight per pallet [kg]	320	310		
Nominal thermal resistance R _D [m ² K/W]	2.50	3.00	3.50	4.00
sd value [m]	0.40	0.48	0.56	0.64



Joint type	Flush-mount			
Thickness [mm]	20	40	60	80
Length × width [mm × mm]	1250 × 590			
m ² /Piece(s)	0.73			
Weight per board [kg]	2.40	4.70	7.10	9.40
Weight per m ² [kg]	3.20	6.40	9.60	12.80
Piece(s)/Pallet	224	112	70	56
Square metres per pallet [m ²]	165.20	82.60	51.62	41.30
Weight per pallet [kg]	590	510	480	490
Nominal thermal resistance R _D [m ² K/W]	0.50	1.00	1.50	2.00
sd value [m]	0.08	0.16	0.24	0.32

Joint type	Flush-mount					
Thickness [mm]	80	100	120	80	100	120
Length × width [mm × mm]	2600 × 1250			2800 × 1250		
m ² /Piece(s)	3.25			3.50		
Weight per board [kg]	41.60	52.00	62.40	44.80	56.00	67.20
Weight per m ² [kg]	12.80	16.00	19.20	12.80	16.00	19.20
Piece(s)/Pallet	12	9	8	12	9	8
Square metres per pallet [m ²]	39.00	29.25	26.00	42.00	31.50	28.00
Weight per pallet [kg]	520			550	520	550
Nominal thermal resistance R _D [m ² K/W]	2.00	2.50	3.00	2.00	2.50	3.00
sd value [m]	0.32	0.40	0.48	0.32	0.40	0.48



GUTEX Thermowall

PRODUCT INFORMATION

Areas of use

- Plaster baseboard for Thermowall ETICS for wood and solid construction without rear ventilation

Advantages

- Excellent sound insulation
- Shockproof
- Outstanding heat storage capacity → protection from heat in summer and cold in winter
- Steam vapour-permeable
- Wood as the sustainable raw material → recyclable
- Manufactured in the direct vicinity of Switzerland (Waldshut, Black Forest)
- Ecologically safe (natureplus® certified)

Installation instructions

- For full, detailed instructions on board installation, fastenings, and render application, see the brochure 'Thermowall ETICS, the ecological thermal insulation system'.
- Note the legal requirements for handling wood dust

Assembly over Timber or Masonry

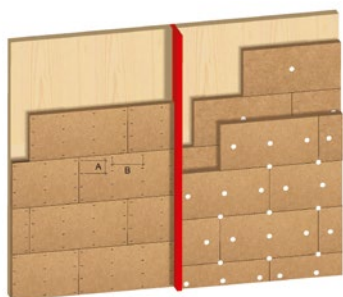

Over Timber Wall

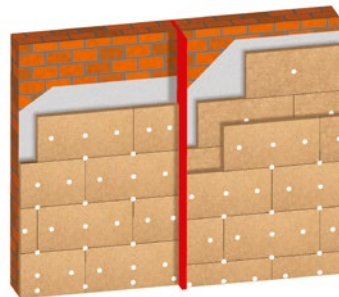

Over Masonry

Assembly in Timber Frame

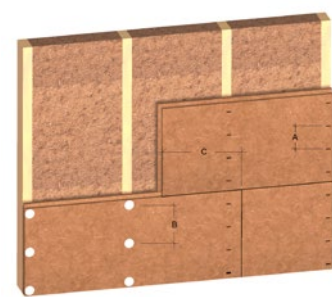

In Timber Frame

