

# Technical data sheet

## GUTEX THERMOSAFE-nf



GUTEX Thermosafe-nf is the impact sound insulation board with a spruce installation strip – ideal as a substructure for screws floorboards or parquet floors.

### Ingredients

- Untreated fir and spruce
- 4.0 % PUR resin

### Disposal

- Waste code numbers as per AVV 030105, 170201

Bulk density $\rho$ [kg/m <sup>3</sup> ]	~ 130
Nominal thermal conductivity $\lambda_D$ [W/mK]	0.039
Vapour diffusion $\mu$	3
Dynamic stiffness [MN/m <sup>3</sup> ]	≤ 50
Compressibility with live loads ≤ 5 kPa [mm]	2
Air flow resistivity [kPa s/m <sup>2</sup> ]	≥ 100
Specific heat capacity [J/kgK]	2100
Maximum working temperature [°C]	110
Fire reaction Euro Class as per EN 13501-1	E
Product standard	EN 13171
Board designation	WF-EN13171-T7-CP2-SD50-CS(10/Y)100-MU3-AF,55



# Technical data sheet

## GUTEX THERMOSAFE-nf

Joint type	Tongue and groove
Thickness [mm]	40
Length × width [mm × mm]	1190 × 380
Actual coverage: Length × width [mm × mm]	1170 × 360
Actual coverage: Square metres per board [m <sup>2</sup> ]	0.42
m <sup>2</sup> /Piece(s)	0.45
Demand/m <sup>2</sup> [Piece]	2,2
Weight per board [kg]	2.35
Weight per m <sup>2</sup> [kg]	5.20
Piece(s)/Pallet	75
Square metres per pallet [m <sup>2</sup> ]	33.91
Weight per pallet [kg]	200
Nominal thermal resistance R <sub>D</sub> [m <sup>2</sup> K/W]	1.00
sd value [m]	0.12



## Product information

### GUTEX THERMOSAFE-nf

#### Areas of use

- As substructure for screwed floorboards and parquet floors

#### Benefits

- Significant impact sound improvement
- More pleasant to walk on
- Quick and easy installation due to profile system and handy board format
- Decoupling of the installation strips for avoidance of sound bridges
- Dry installation for quick construction progress
- Outstanding thermal insulation
- Outstanding heat storage capacity → good protection from heat in summer and cold in winter
- Moisture-regulating
- Vapour-permeable
- Wood as the sustainable raw material → recyclable
- Manufactured in the direct vicinity of Switzerland (Waldshut, Black Forest)
- Ecologically safe (natureplus® certified)

#### Installation instructions

- Store and work with the boards in a dry place
- Install strips with lettering facing upwards, boards with lettering facing downwards
- Create a dry, level, and technically perfect substrate
- Apply moisture barrier (DIN 18195)
- Apply edge strips up to upper edge of GUTEX Thermosafe-nf
- Allow at least 20 mm clearance to the wall, leave clearance of 1-3 mm between the installation strips (see drawing below).
- Joint offset of the installation strip min. 1 m from strip to strip
- Beginning and end board at least 12 cm wide
- Board centre to board centre spacing = 41.4 cm
- Cut to size: GUTEX cutting blade for jigsaws or portable circular saw with extractor unit
- With greater insulation thicknesses under GUTEX Thermosafe-nf, use GUTEX Thermosafe-wd up to max. 100 mm
- Minimum thickness of the floor board/parquet strip 19 mm
- There must be at least two fastening points per floor board/strip
- GUTEX Thermosafe-nf must be installed over the entire surface. Interruptions, e.g. due to installations, are not permitted
- With moisture-sensitive floor boards, e.g. beech, birch, or ruby, we recommend laying 2 system strips glued together with butt joints using PVA glue
- Note the legal requirements for handling wood dust

## Floor structure

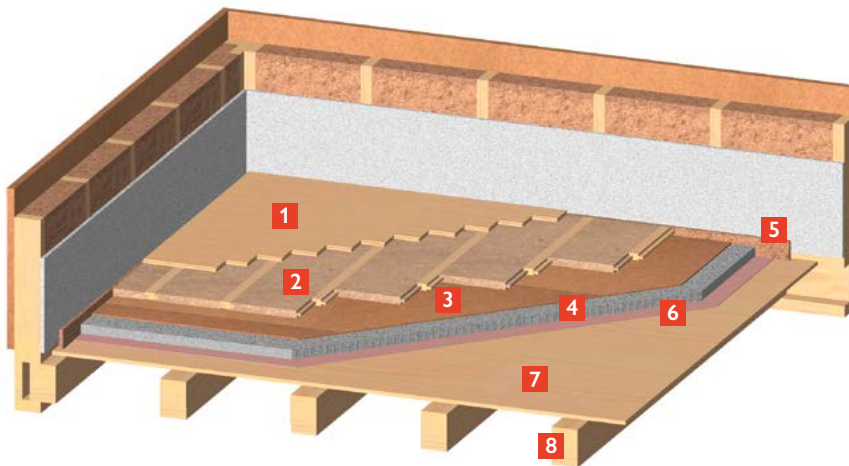

- 1 Solid wood floor
- 2 GUTEX Thermosafe-nf
- 3 GUTEX Standard-n
- 4 Filling (pressure-resistant)
- 5 Edge strip
- 6 Trickle protection paper
- 7 Exposed formwork
- 8 Exposed beam layer

## Installation diagram

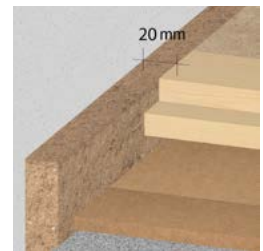
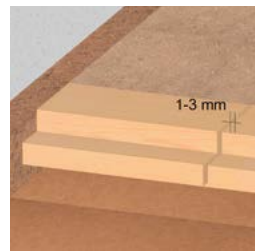
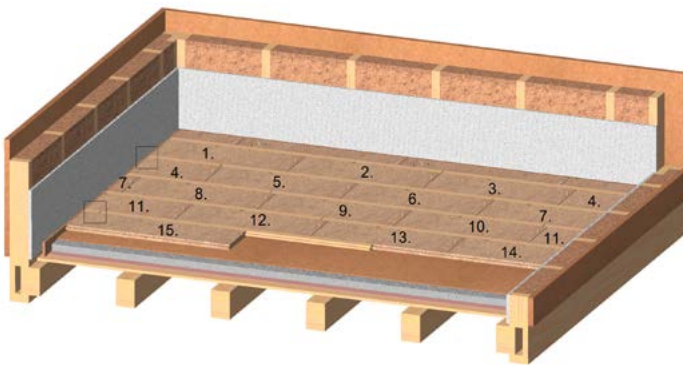

- Install GUTEX Thermosafe-nf in a bond pattern.
- The remaining piece in one installation row is placed at the beginning of the next row.



GUTEX Holzfaserplattenwerk H. Henselmann GmbH + Co. KG  
 Gutenberg 5, D-79761 Waldshut-Tiengen, Phone +49 7741 6099-0, info@gutex.de, www.gutex.de

